

8¾" Handle
Swing Radius

INLET
Connect to pipe
drop from fire
protection system.

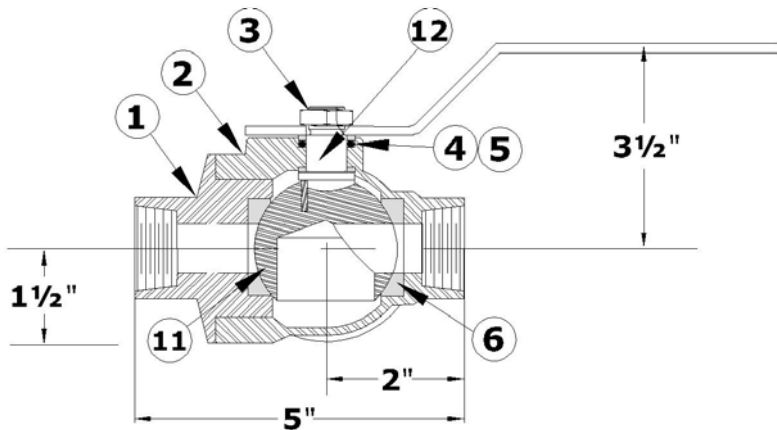
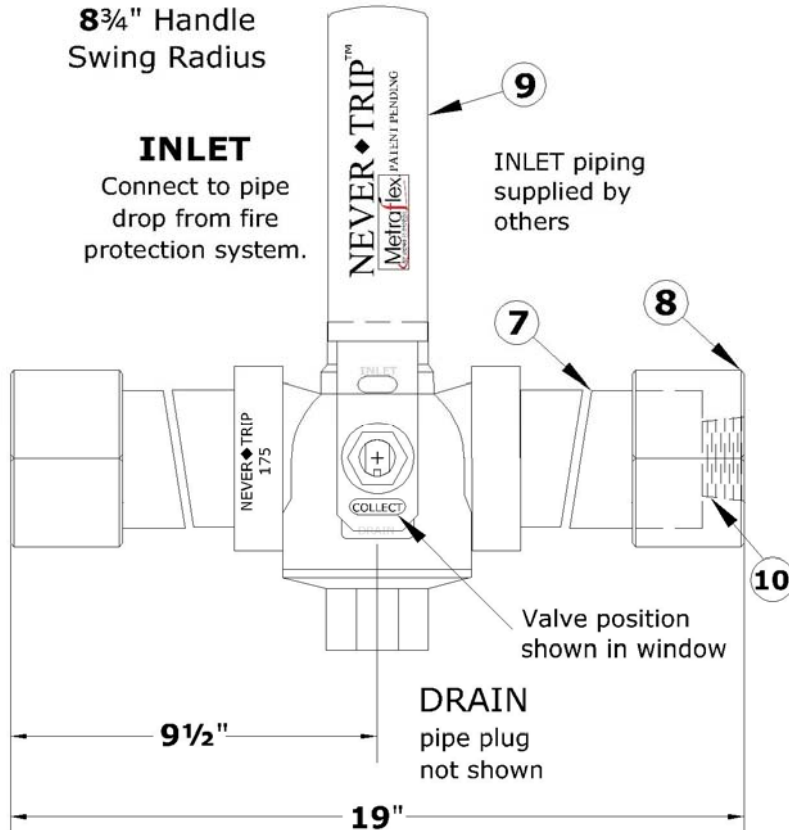

NEVER TRIP™

Auxiliary Condensate Drain Valve
Assembly for Dry Systems

Conforms to the requirements of
NFPA 13 for an Auxiliary Drain Valve

Ends - 1" NPT female thread

Pressure rating - 175 psi

Max temperature rating - 200 F

OPTION - 1 extended chamber for
corner installation

NEVER TRIP PARTS LIST

Item	Qty	Description	Material
1	1	Drain Outlet	Steel, zinc plated
2	1	Body	Steel, zinc plated
3	1	Hex Nut	Steel, zinc plated
4	1	Stem Seal	Nitrile
5	2	Thrust Washer	PTFE
6	2	Seat	PTFE
7	2	Chamber	Steel, zinc plated
8	2	End Cap	Steel, zinc plated
9	1	Handle	Steel, chromate plate
10	1	Sight Glass	Thermoplastic
11	1	Ball	Steel, nickel plate
12	1	Stem	Stainless Steel
13	1	Pipe Plug (not shown)	Steel, chromate plate

Qty	Location/Notes

CUSTOMER _____

PROJECT _____

ENGINEER _____

ARCHITECT _____

PRO. OR P.O. NO. _____

Metroflex.

for pipes in motion Chicago, IL

DESCRIPTION:

NEVER TRIP™

Auxiliary Condensate Drain Valve

DRAWING BY:
BP

DATE:
1/26/07

DRAWING NO.
NT VALVE